

# SPARE PARTS SECTION

The following section covers the spare parts diagrams and lists that were current at the time this manual was originally printed. Due to continuous improvements of the machine, changes may be made at any time without notification.

## HOW TO ORDER SPARE PARTS

1. Have your machines **model number, serial number & date of manufacture** on hand, these can be found on the specification plate mounted on the machine
2. A scanned copy of your parts list/diagram with required spare part/s identified
3. Go to [www.machineryhouse.com.au/contactus](http://www.machineryhouse.com.au/contactus) and fill out the enquiry form attaching a copy of scanned parts list.

## CONTENTS

B.HeadBodyPartsList.....	21
C. TableColumnList.....	23



# OPERATION MANUAL

## B. HEAD BODY PARTS LIST

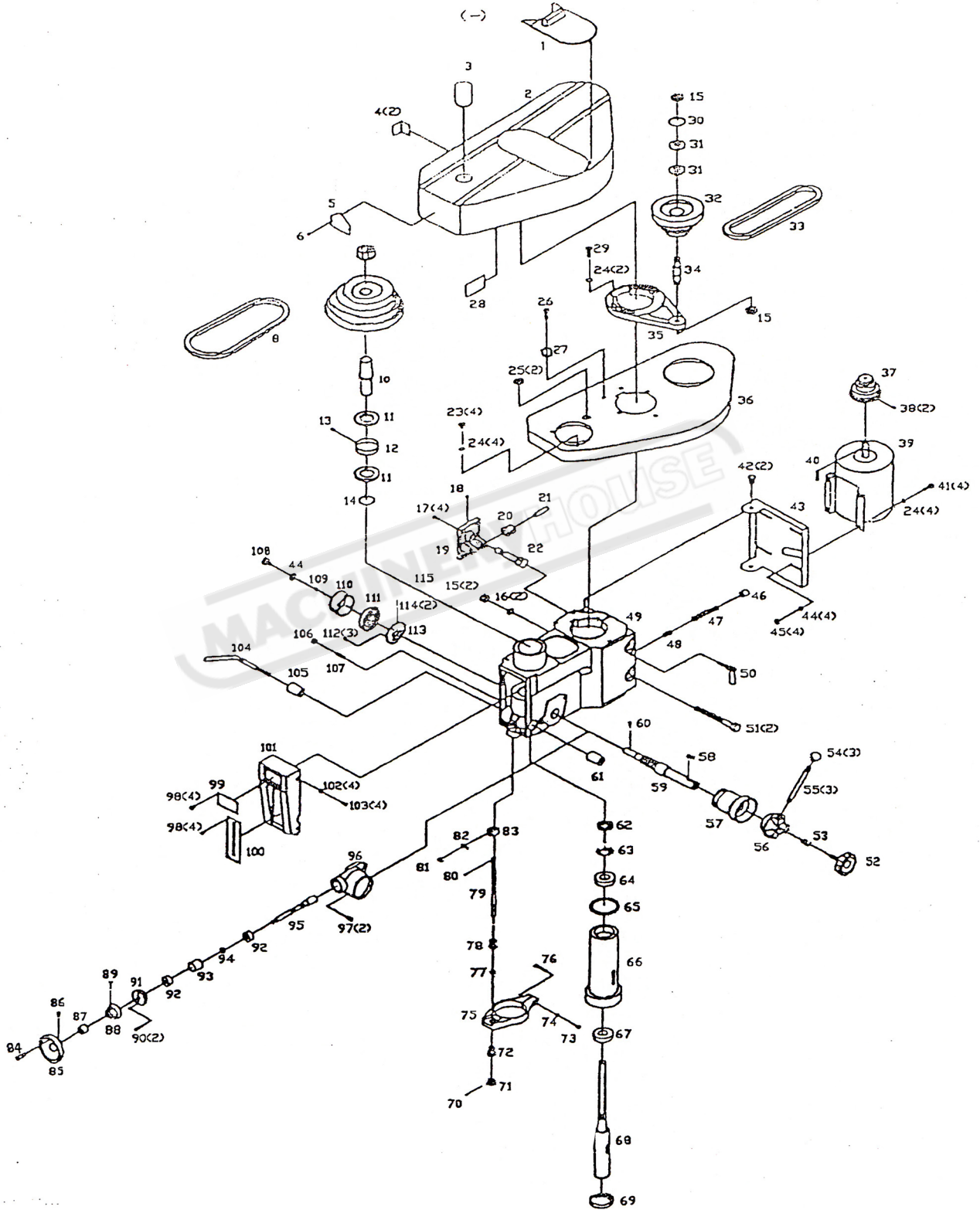

## OPERATION MANUAL

### B. HEAD BODY PARTS LIST

NO.	NAME	NO.	NAME	NO.	NAME
1	cover board	39	motor	77	nut
2	up cover	40	key	78	fixed nut
3	round	41	bolt	79	adjustable rod
4	jaw	42	bolt	80	pin
5	trademark	43	motor rack	81	screw
6	rivet	44	washer	82	referral-board
7	nut	45	nut	83	stop lump
8	V-belt	46	balata jacketing	84	turn handle
9	spindle ring	47	tension pin	85	small hand wheel
10	splined sleeve	48	spring	86	screw
11	ball bearing	49	spindle box	87	adapter sleeve
12	separating ring	50	tight handle	88	graduation plate
13	screw	51	bolt	89	screw
14	retainging ring	52	big ripple handle	90	bolt
15	nut	53	spring	91	end lid
16	washer	54	handle ball	92	ball bearing
17	screw	55	handle rod	93	separating ring
18	oil cup	56	handle body	94	retainging ring
19	bracket	57	turbine	95	feed worm
20	gear	58	key	96	feed inst. support
21	shaft	59	gear shaft	97	bolt
22	worm	60	screw	98	screw
23	bolt	61	fixed collar thread	99	nameplate
24	washer	62	nut	100	scale
25	separating ring	63	washer	101	front cover board
26	screw	64	ball bearing	102	washer
27	wire californium	65	retaining	103	screw
28	warning board	66	sleeve	104	handle rod
29	bolt	67	ball bearing	105	fixed tight collar
30	retainging ring	68	spindle	106	nut
31	ball bearing	69	ball bearing lid	107	screw
32	middle pulley	70	pin	108	small ripple handle
33	V-belt	71	knob	109	washer
34	middle pulley shaft	72	locating sleeve	110	spring cap
35	pulley support	73	nut	111	spring plate
36	down cover	74	washer	112	screw
37	motor pulley	75	feed support	113	shaft sleeve
38	screw	76	bolt	114	pin



OPERATION MANUAL

C. TABLE COLUMN PARTS LIST

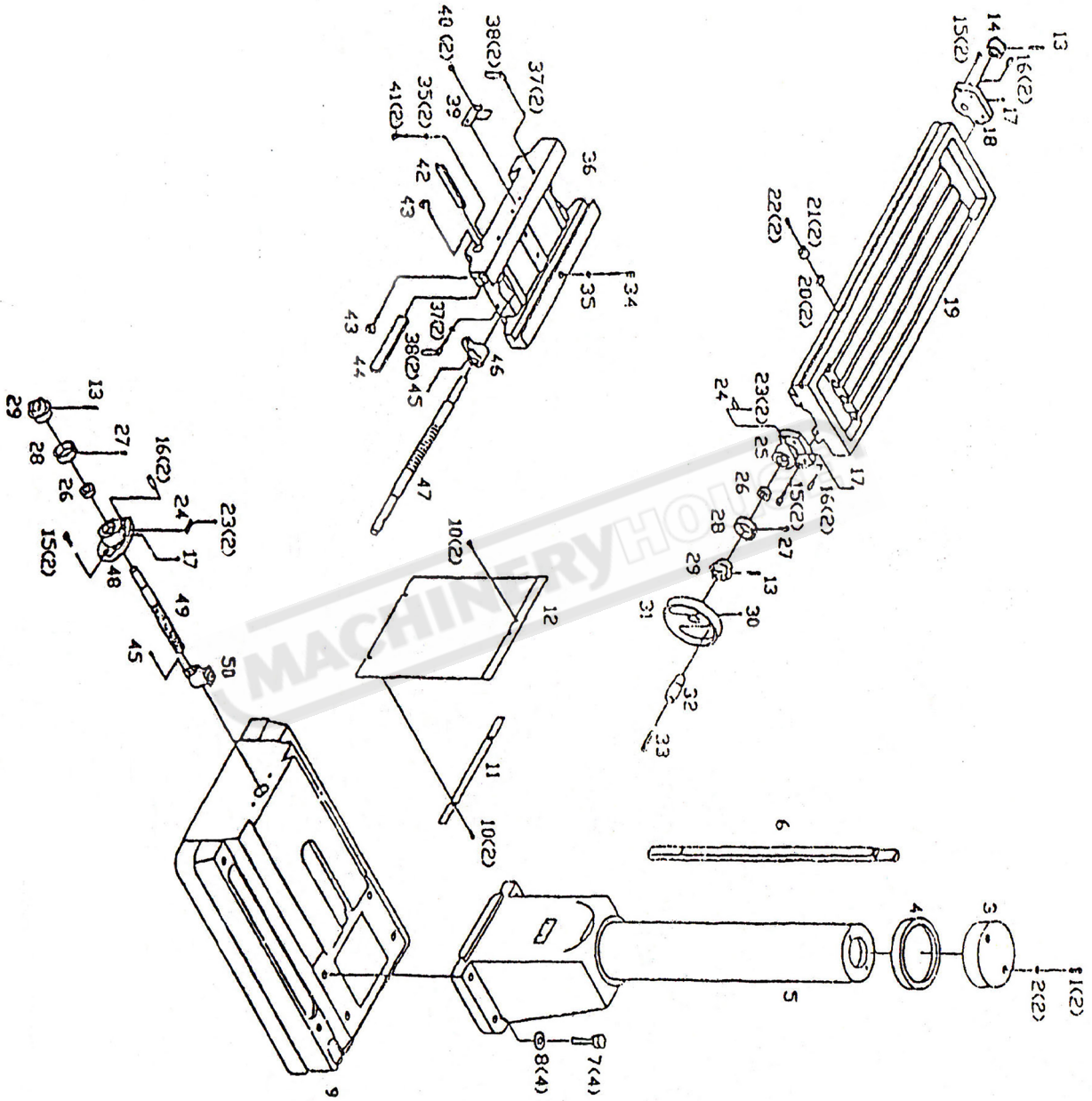

**OPERATION MANUAL**

---

**C. TABLE COLUMN PARTS LIST**

<b>NO.</b>	<b>NAME</b>	<b>NO.</b>	<b>NAME</b>
1	Screw	26	Ball Bearing
2	washer	27	Screw
3	Column Lid	28	Graduatiot Plate
4	Link	29	Dial Clutch
5	Column	30	screw
6	Rack	31	Hand Wheel
7	Bolt	32	Turn Handle
8	Washer	33	Screw
9	Base	34	Screw
10	Bolt	35	Washer
11	Protect Board Slice	36	Slip Saddle
12	Protect Board	37	Steel Ball
13	Pin	38	Lock Handle
14	Left Diai Clutch	39	Stop Lump
15	Screw	40	Bolt
16	Pin	41	Screw
17	Oil Cup	42	Gib Srrip
18	Left Support	43	Gib Srrip Screw
19	Table	44	Gib Srrip
20	Ladder-Shaped Nud	45	Screw
21	Stop Lump	46	Guide Screw Nut
22	Screw	47	Guide Screw
23	Rivew	48	Guide Screw Support
24	Zero Site Board	49	Guide Screw
25	Right Support	50	Guide Screw Nut